

STEAM INJECTORS SI115

DESCRIPTION

The SI115 series steam injectors from ADCA are condensate injectors. They ensure low noise and vibration and rapid heating of still or flowing fluids in basins and vessels, due to direct steam injection. Steam enters through the inlet housing, passes along the centre of the heater, mixing with the cool water, which is drawn in through radial holes.



MAIN FEATURES

Quiet operation.
Corrosion-resistant.
No moving parts.

OPTIONS: Complete system including vacuum breaker and self operated controller.
Different capacities and designs available under request.

USE: Direct steam injection heating systems.

AVAILABLE MODELS: SI115.

SIZES: 1/2".

CONNECTIONS: Female threaded ISO 7 Rp.

INSTALLATION: Horizontal installation.
See IMI – Installation and maintenance instructions.

MATERIAL: AISI 316 / 1.4401.

CAPACITY CHART
(With vessel at atmospheric pressure)

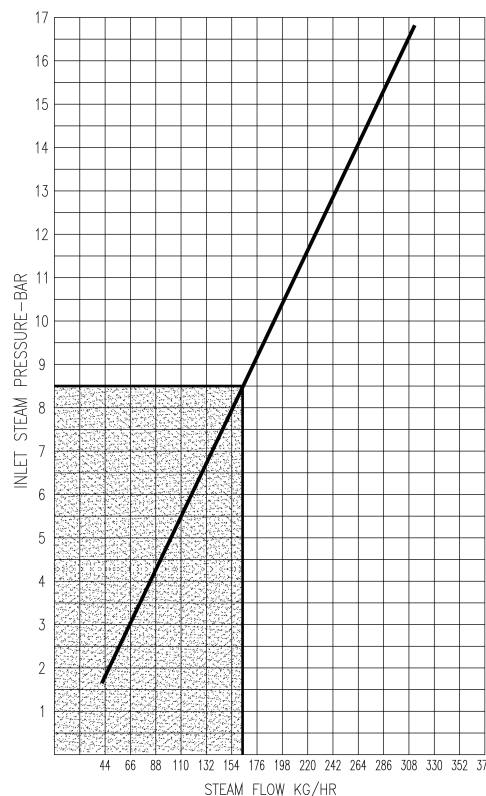

Remark: Selection under shadow area is recommended for the quietest operation.

LIMITING CONDITIONS	
Body design conditions	PN 25
PMO – Maximum operating pressure	17 bar
TMO – Maximum operating temperature	95 °C

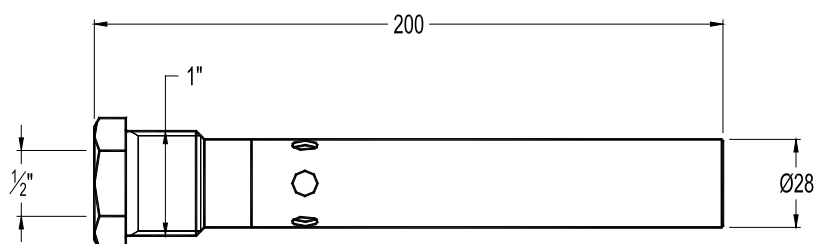

Example: We require the injection of 230 kg/h of steam with a pressure of 5,5 bar. From the injector capacity chart, we see that, at 5,5 bar the injector will process 110 kg/h and 230 divided by 110 = 2,09. Two injectors will barely cope, so it is recommended to install three injectors, which will meet the demand.