

SANITARY PRESSURE GAUGES SMAN-63

DESCRIPTION

The ADCAPure SMAN-63 are reliable general purpose sanitary bourdon tube pressure gauges designed for pressure measurement of liquid and gaseous media. These units have a size diameter of 63 mm, range marked in bar and are fully manufactured in stainless steel.

MAIN FEATURES

Compact full stainless steel construction.
Wetted parts in AISI 316L / 1.4435 – flush diaphragm.
Designed according to EN 837-1.
Bayonet lock case with blow-out.
Suitable to be filled with glycerine.

USE: Gases and liquids compatible with the construction.

AVAILABLE MODELS: SMAN-63R – radial connection.
SMAN-63A – axial connection.

SIZES: 3/4".

CONNECTIONS: ASME BPE clamp ferrules.
Others on request.

MEASURING RANGES: 0 to 4 bar, 0 to 6 bar, 0 to 10 bar and 0 to 16 bar.

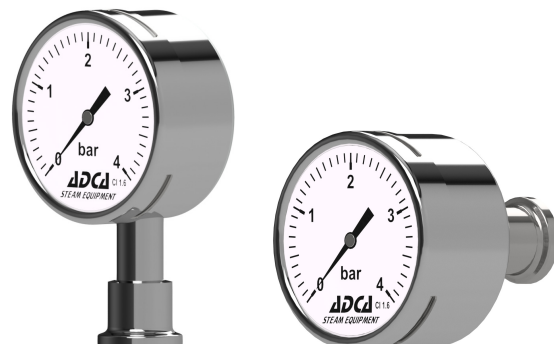

LIMITING CONDITIONS	
Accuracy	±2,5% FS
IP rating	IP 65
Maximum allowable pressure	Full scale reading
Maximum operating temperature	120 °C *
Minimum operating temperature	-20 °C
Ambient temperature	-10 to 60 °C

* 150 °C for short term (cleaning).

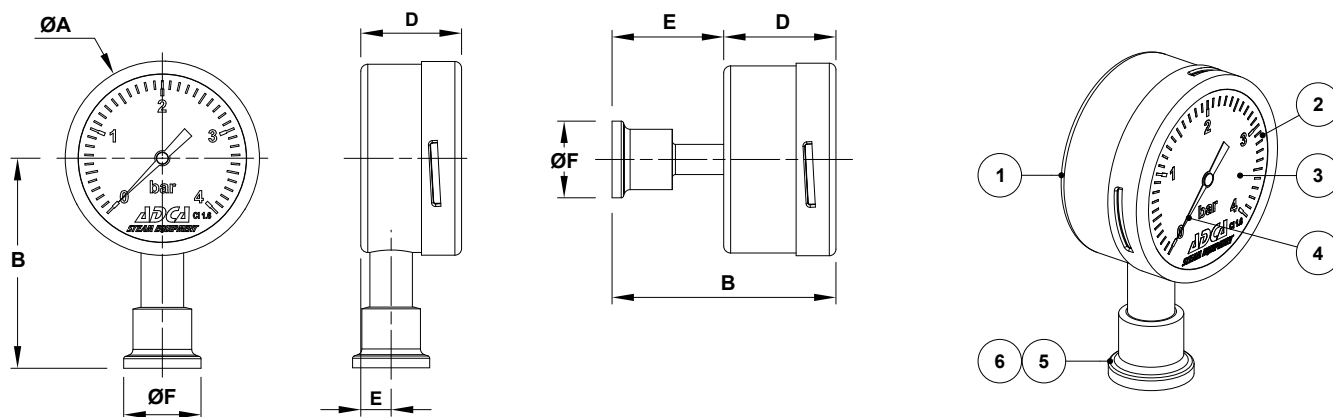

DIMENSIONS (mm)

MODEL	ØA	B	D	E	ØF	WEIGHT (kg)
SMAN-63R	63,8	69	33,2	10	25,4	0,2
SMAN-63A	63,8	74,2	37,2	37	25,4	0,4

MATERIALS

POS. N°	DESIGNATION	MATERIAL	POS. N°	DESIGNATION	MATERIAL
1	Case and bezel ring	AISI 304 / 1.4301	4	Pointer	Black aluminium
2	Window	Glass	5	Connection	AISI 316L / 1.4435
3	Dial	White aluminium	6	Measuring system	AISI 316L / 1.4435