

AIR AND GAS FLOAT TRAPS FA35.3 (Carbon steel 1 1/2" – 2"; DN 40 – 50)

DESCRIPTION

The FA35.3 is a range of fully automatic ball float traps specially designed for condensate drainage in compressed air and gas systems. Typical applications include aftercoolers, separators and compressed air mains.

MAIN FEATURES

Modulating discharge.
Unaffected by sudden or wide load and pressure variations.
Flow direction can be easily changed by repositioning the body in relation to the mechanism and cover.

OPTIONS: Equalizing (vent) and drain connections.
BDV – Blowdown valve.
AFZ – Anti-freeze device.
FLL – Float lifting lever.

USE: Compressed air and other non corrosive gases compatible with the construction.

AVAILABLE MODELS: FA35.3-4,5 , 10 , 14 , 21 and 32 – carbon steel.

SIZES: 1 1/2" to 2"; DN 40 to DN 50.

CONNECTIONS: Female threaded ISO 7 Rp or NPT.
Flanged EN 1092-1 PN 40.
Flanged ASME B16.5 Class 150 or 300.
Socket weld (SW) ASME B16.11.

INSTALLATION: Horizontal or vertical installation.

MAX. ΔP: FA35.3-4,5 – 4,5 bar
FA35.3-10 – 10 bar
FA35.3-14 – 14 bar
FA35.3-21 – 21 bar
FA35.3-32 – 32 bar



CE MARKING – GROUP 2 (PED – European Directive)

| CLASS 150 | PN 40 | Category |
|----------------------------|----------------------------|---------------|
| 1 1/2" to 2" – DN 40 to 50 | – | SEP |
| – | 1 1/2" to 2" – DN 40 to 50 | 1 (CE marked) |

| BODY LIMITING CONDITIONS | | |
|-----------------------------|----------------------|---------------|
| FLANGED PN 40 / CLASS 300 * | FLANGED CLASS 150 ** | RELATED TEMP. |
| ALLOWABLE PRESSURE | ALLOWABLE PRESSURE | |
| 40 bar | 17,7 bar | 100 °C |
| 40 bar | 14 bar | 200 °C |
| 39 bar | 12,1 bar | 250 °C |
| 35,2 bar | 10,2 bar | 300 °C |

PMO – Max. operating pressure: 32 bar.
TMO – Max. operating temperature: 250 °C.
Min. liquid specific weight: 0,75 kg/dm³.
* Acc. to EN 1092-1:2018; ** Acc. to EN 1759-1:2004.
Body limiting conditions PN 40 or below, depending on the type of connection adopted. Rating PN 40 for threaded, SW and BW versions.

FLOW RATE CAPACITY (kg/h)

| MODEL | SIZE | DIFFERENTIAL PRESSURE (bar) | | | | | | | | | | | | |
|------------|----------------------------|-----------------------------|------|------|------|------|------|------|------|------|------|------|------|------|
| | | 0,5 | 1 | 1,5 | 2 | 4,5 | 7 | 10 | 12 | 14 | 16 | 21 | 25 | 32 |
| FA35.3-4,5 | 1 1/2" to 2" – DN 40 to 50 | 995 | 1450 | 1710 | 2000 | 2990 | – | – | – | – | – | – | – | – |
| FA35.3-10 | 1 1/2" to 2" – DN 40 to 50 | 505 | 720 | 850 | 1010 | 1600 | 1890 | 2300 | – | – | – | – | – | – |
| FA35.3-14 | 1 1/2" to 2" – DN 40 to 50 | 370 | 520 | 610 | 735 | 1150 | 1430 | 1620 | 1750 | 1980 | – | – | – | – |
| FA35.3-21 | 1 1/2" to 2" – DN 40 to 50 | 305 | 430 | 515 | 600 | 900 | 1160 | 1435 | 1590 | 1620 | 1760 | 1995 | – | – |
| FA35.3-32 | 1 1/2" to 2" – DN 40 to 50 | 175 | 230 | 290 | 340 | 505 | 625 | 745 | 815 | 900 | 955 | 1125 | 1250 | 1480 |

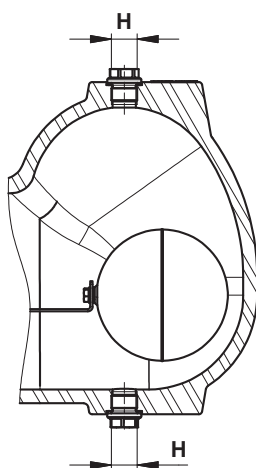
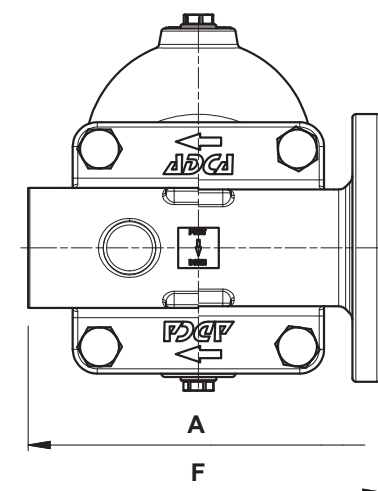
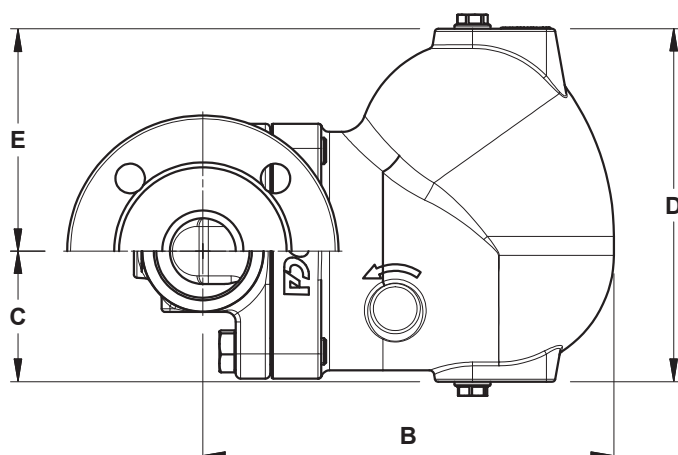

DIMENSIONS (mm)

| SIZE | THREADED / SW | | | | | | | PN 40 | | | CLASS 150 | | | CLASS 300 | | |
|----------------|---------------|-----|----|-----|-----|------|-----------|-------|-----|-----------|-----------|-----|-----------|-----------|-----|-----------|
| | A | B | C | D | E | H * | WGT. (kg) | F | B | WGT. (kg) | F | B | WGT. (kg) | F | B | WGT. (kg) |
| 1 1/2" – DN 40 | 210 | 250 | 80 | 215 | 136 | 3/8" | 18,9 | 230 | 250 | 21,7 | 230 | 250 | 20,2 | 230 | 250 | 21,5 |
| 2" – DN 50 | 210 | 250 | 80 | 215 | 136 | 3/8" | 18,2 | 230 | 250 | 23,6 | 230 | 250 | 21,5 | 230 | 250 | 23,2 |

* As standard, in versions with EN flanges and female ISO 7 Rp threads, these connections are female threaded ISO 228. In versions with ASME flanges, female NPT threads or SW, these connections are female threaded NPT.

| MATERIALS | | |
|-----------|--------------------|---|
| POS. N° | DESIGNATION | MATERIAL |
| 1 | Body | A216 WCB / 1.0619 |
| 2 | Cover | A216 WCB / 1.0619 |
| 3 | * Gasket | Stainless steel / Graphite |
| 4 | * Seat | AISI 410 / 1.4006 |
| 4A | Mounting plate | AISI 316 / 1.4401 |
| 5 | * Gasket | Graphite |
| 6 | * Valve ball | AISI 440C / 1.4125 |
| 7 | * Lever | AISI 304 / 1.4301 |
| 8 | * Float | AISI 304 / 1.4301 |
| 10 | Bolts | Zinc plated steel |
| 11 | Plug | AISI 316L / 1.4404 |
| 12 | ** Gasket | Copper; AISI 304 / 1.4301 |
| 31 | Lever mechanism | AISI 303 / 1.4305 ; AISI 304 / 1.4301; AISI 316L / 1.4404 |
| 32 | Packing | Graphite |
| 33 | Lever | Plastic |
| 51 | Blowdown valve | AISI 303 / 1.4305; AISI 316L / 1.4404 |
| 61 | Anti-freeze device | AISI 303 / 1.4305; AISI 316L / 1.4404 |

* Available spare parts; ** Not applicable in NPT version.

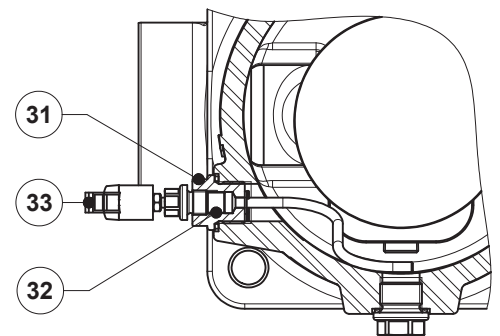
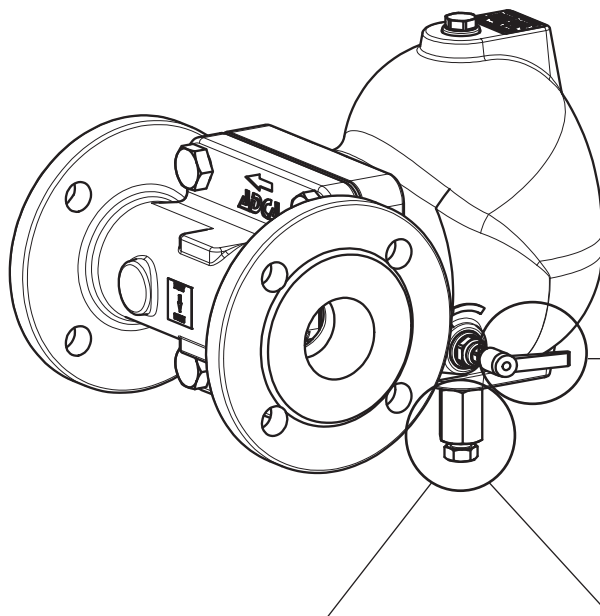
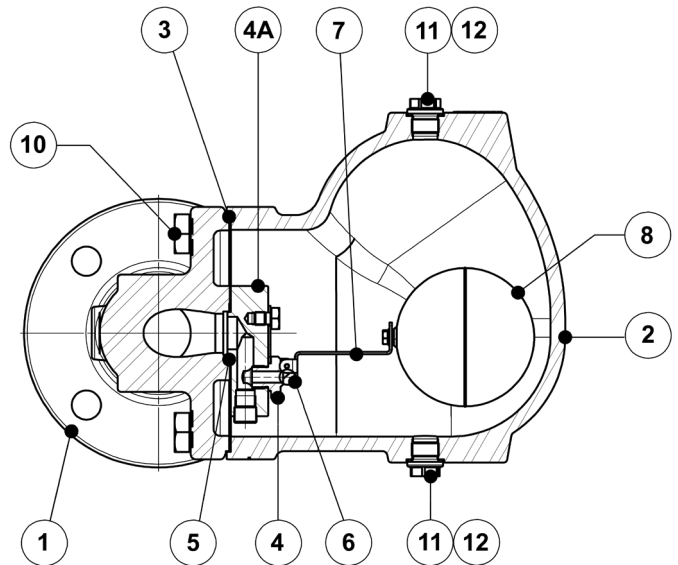

FLL - Float lifting lever

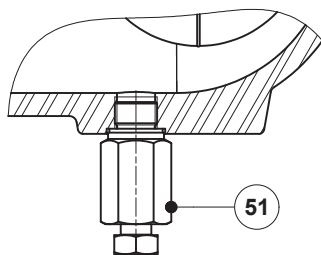

BDV - Blowdown valve
(Manual)

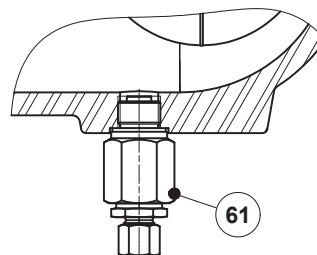

AFZ - Anti-freeze device
(Automatic)

FLOW DIRECTION

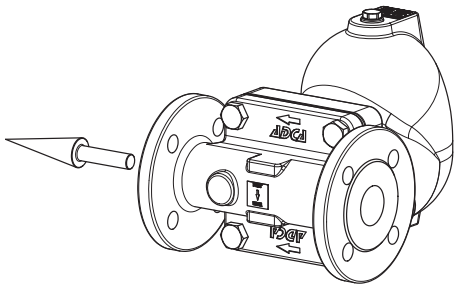

R - Horizontal from right to left

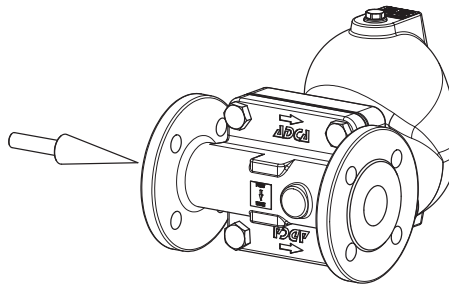

L - Horizontal from left to right

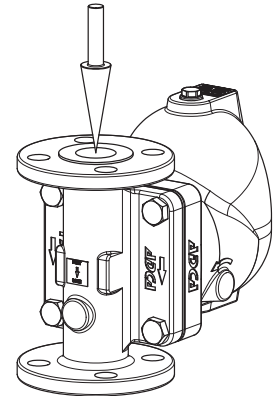

V - Vertical from top to bottom

ORDERING CODES FA35.3

| Model | | FA353 | 2 | M | XX | X | IR | A | 40 |
|--|--|-------|---|---|----|---|----|---|----|
| FA35.3 – A216 WCB / 1.0619 carbon steel | | FA353 | | | | | | | |
| Differential pressure | | | | | | | | | |
| 4,5 bar | | | 2 | | | | | | |
| 10 bar | | | 3 | | | | | | |
| 14 bar | | | 4 | | | | | | |
| 21 bar | | | 5 | | | | | | |
| 32 bar | | | 7 | | | | | | |
| Valve sealing | | | | | | | | | |
| Metal to metal | | | | M | | | | | |
| Cover connections | | | | | | | | | |
| None | | | | | XX | | | | |
| 3/8" threaded connections on top and bottom, closed with plugs (mandatory if any options are considered) | | | | | 10 | | | | |
| Options | | | | | | | | | |
| BDV and AFZ have specific separated ordering codes, please refer to the appropriate documentation. | | | | | | | | | |
| FLL - Float lifting lever | | | | | | | | | |
| None | | | | | | X | | | |
| Lifting lever on the right side (when facing the steam trap body) | | | | | | R | | | |
| Lifting lever on the left side (when facing the steam trap body) | | | | | | L | | | |
| Flow direction | | | | | | | | | |
| Horizontal from right to left – standard | | | | | | | IR | | |
| Horizontal from left to right | | | | | | | IL | | |
| Vertical from top to bottom | | | | | | | IT | | |
| Pipe connections | | | | | | | | | |
| Female threaded ISO 7 Rp | | | | | | | | A | |
| Female threaded NPT | | | | | | | | C | |
| Socket weld (SW) ASME B16.11 | | | | | | | | H | |
| Flanged EN 1092-1 PN 40 | | | | | | | | N | |
| Flanged ASME B16.5 Class 150 | | | | | | | | U | |
| Flanged ASME B16.5 Class 300 | | | | | | | | V | |
| Size | | | | | | | | | |
| 11/2" or DN 40 | | | | | | | | | 40 |
| 2" or DN 50 | | | | | | | | | 50 |
| Special valves / Extras | | | | | | | | | |
| Full description or additional codes have to be added in case of a non-standard combination | | | | | | | | | E |